

建築構造力学1A・同演習 第2回 中間試験 実施日2012/06/20	学生証 番号	氏名	解答	得点
---	-----------	----	----	----

軸力図 (AFD)、せん断力図 (SFD)、曲げモーメント図 (BMD) を図中に描きなさい。
ただし各断面力が部材内ですべて0の場合は、0を図に書きなさい。

(1)

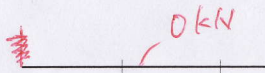
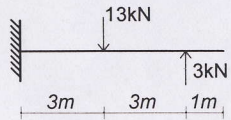

AFD

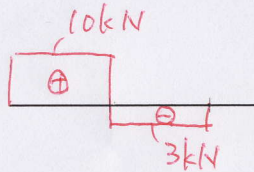

SFD

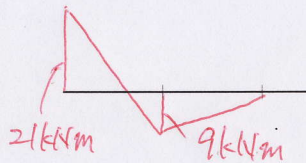

BMD

(2)

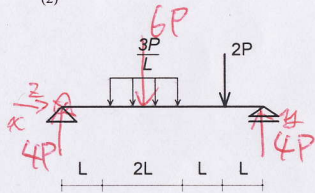

$$\begin{aligned} \sum X_i &= z = 0 \\ \sum Y_i &= x + y - 6P - 2P = 0 \\ \sum M_i &= 6P \times 2L - 2P \times 4L - y \times 5L = 0 \\ x &= 4P, y = 8P, z = 0 \end{aligned}$$

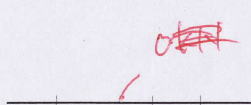

AFD

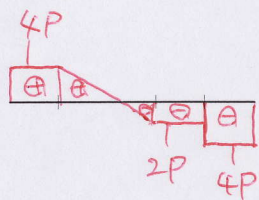

SFD

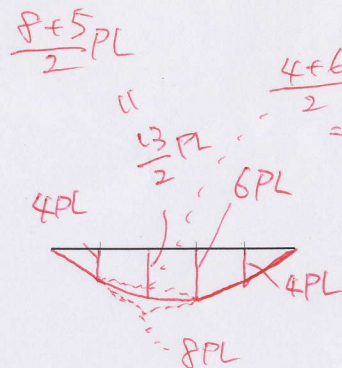

BMD

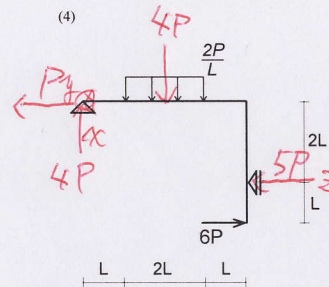

$$\begin{aligned} \sum X_i &= -y - z + 6P = 0 \\ \sum Y_i &= x - 4P = 0 \\ \sum M_i &= 4P \times 2L + 2 \times 2L - 6P \times 3L = 0 \\ x &= 4P, y = P, z = 5P \end{aligned}$$

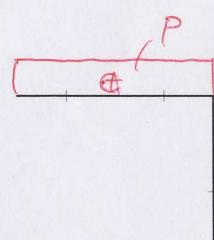

AFD

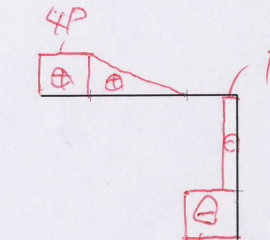

SFD

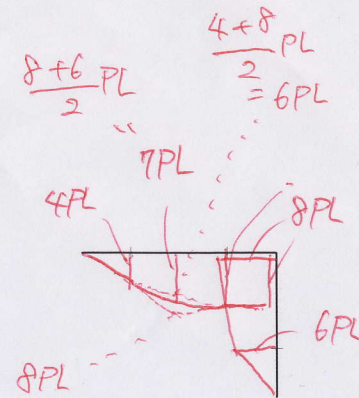

BMD

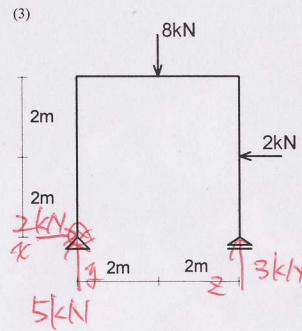

$$\begin{aligned} \sum X_i &= x - 2kN = 0 \\ \sum Y_i &= y + z - 8kN = 0 \\ \sum M_i &= 8kN \times 2m - 2kN \times 2m - z \times 4m = 0 \\ x &= 2kN, y = 5kN, z = 3kN \end{aligned}$$

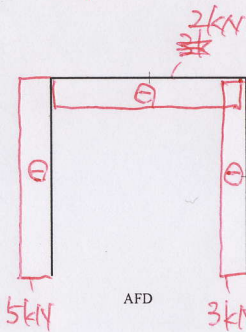

AFD

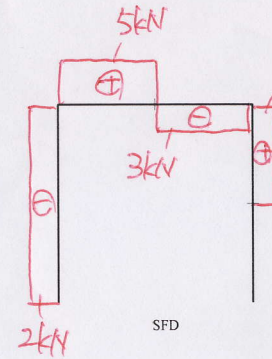

SFD

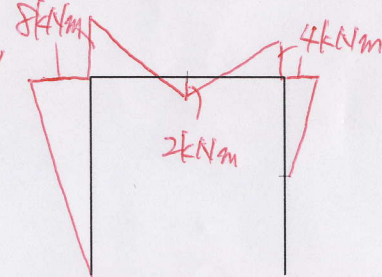

BMD